



PRODUCT OVERVIEW

The EV-RM-9 monitors solar panel voltage, battery voltage, charge current, load current, charge capacity, discharge capacity, temperature, and fault codes.

FEATURES

- LCD screen with backlights
- Supports real-time data display and parameter settings
- Communications line integrates with power supply and communications Mod1 RM-9 functionality
- Adopts RS-485 communications mode to automatically adapt baud rate input voltage of the controller from 5V-12V
- Convenient magnetically attached cover

APPLICATIONS

- Remote monitoring

Product Description

PART#	DESCRIPTION	COMMUNICATION	INTERFACE
EV-RM-9	Remote Meter	RS485	RJ45

Specifications

MODEL#	EV- RM-9
Input Voltage	5V-12V
Stand-by Power Consumption	<0.1W
Operational Power Consumption	<0.36W
Communication Baud Rate	1200-11520bps
Communication Method	RS485
Communication Interface	RJ45
Cable Length	6.0m
Operating Temperature	-35°C ~ +65°C
Protection Grade	IP65
Weight	90g
Product Dimensions	79*52*32mm

Product Details

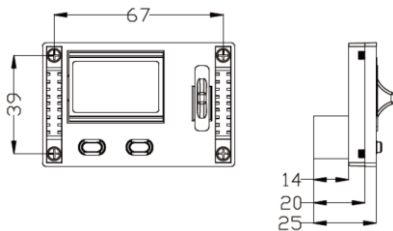

DIMENSIONS

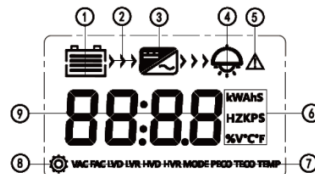

No.	Name	No.	Name
①	Battery	⑥	Unit display
②	Inverter indication	⑦	Setting stage
③	Inverter	⑧	Setting indication
④	AC load	⑨	Parameter display
⑤	System alarm		

LCD MENU

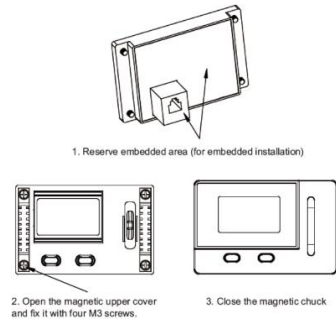

INSTALLATION